

Request From: \_\_\_\_\_  
Company Name: \_\_\_\_\_  
Phone Number: \_\_\_\_\_  
Email: \_\_\_\_\_

Project Name: \_\_\_\_\_  
Project Address: \_\_\_\_\_  
Ship to Address: \_\_\_\_\_  
Location:  Project  Shop  New Construction

**PROFILE VIEW Insulated**

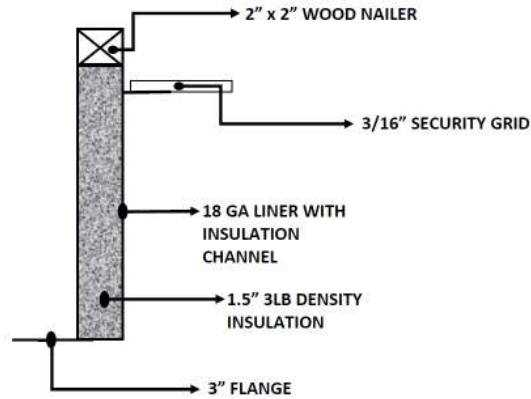

**Standard Features Insulated Curb**

- 18 Gauge, Galvanized steel construction
- 18 Gauge interior liner
- 1 1/2" thick, 3 pound density fiberglass insulation
- Full height mitered and welded corners
- 2"x2" wood nailer
- 3/16" Safety and Security Grid 6"x6" on center, mounted at top of curb
- Pre-primed white interior and grid
- 3" Flange on lower perimeter
- 1 1/2" Curb wall thickness

Insulated Curb Quantity: \_\_\_\_\_

Curb Outside Dimensions: \_\_\_\_\_ X \_\_\_\_\_

Curb Inside Dimensions: \_\_\_\_\_ X \_\_\_\_\_

Curb Height:  9"  12"  14"  Custom \_\_\_\_\_

Product Type:  Skylight  Smoke Vent  Shrink-Out S.V  
 Velux  Sunoptics  Kingspan  \_\_\_\_\_

**Additional Option Requested**

- 14 Gauge 5" On Center One Direction
- Delete Safety Screen
- 1/2" Burglar Bars, 8" x 8" on center grid
- CalOSHA 4"x4" on center grid

**PROFILE VIEW Non-Insulated**

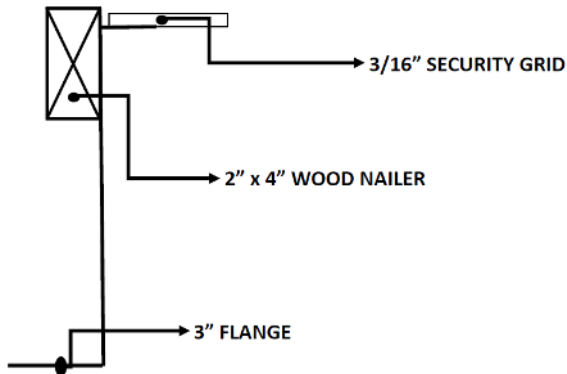

**Standard Features Non-Insulated Curb**

- 18 Gauge, Galvanized steel construction
- Full height mitered and welded corners
- 2"x 4" wood nailer
- 3/16" Safety and Security Grid 6"x6" on center, mounted at top of curb
- Pre-primed white interior and grid
- 3" Flange on lower perimeter
- 1 3/4" Curb wall thickness
- Designed to be insulated in the field by Installer

Non-Insulated Curb Quantity: \_\_\_\_\_

Curb Outside Dimensions: \_\_\_\_\_ X \_\_\_\_\_

Curb Inside Dimensions: \_\_\_\_\_ X \_\_\_\_\_

Curb Height: 9" 12" 14" Custom \_\_\_\_\_

Product Type:  Skylight  Smoke Vent  Shrink-Out S.V

Velux  Sunoptics  Kingspan  \_\_\_\_\_

**Additional Option Requested**

- 14 Gauge 5" On Center One Direction
- Delete Safety Screen
- Add 1/2" Burglar Bars, 8" x 8" on center grid
- CalOSHA 4"x4" on center grid